



3900 Central Parkway

Hudsonville, MI 49426

toll free 800.338.7337

office 616.896.7100

techsupport@soundoffsignal.com

www.soundoffsignal.com

PREDATOR™

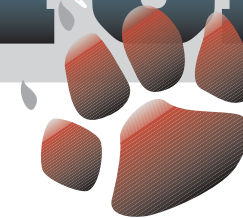

MIRROR MOUNT WARNING SYSTEM ASSEMBLY INSTRUCTIONS PPRDDMMFPI

WARNING: Warning devices are strictly regulated and governed by Federal, State and Municipal ordinances. These devices shall be used ONLY on approved vehicles. It is the sole responsibility of the user of these devices to ensure compliance.



WARNING

This product contains high intensity LED devices. To prevent eye damage, DO NOT stare into light beam at close range.



MOUNTING INSTRUCTIONS

Read all instructions carefully before starting installation. Installation of this product should only be attempted by experienced installers and extreme care must be taken to prevent damage to mirror or door components; holes must be drilled carefully! DO NOT over tighten mounting screws. Special Note: Illustrations C and E on this page show Single Predator; follow instructions carefully.

Note that gaskets are marked for driver's or passenger's side on face and the top side is indicated on the back. **GASKETS ARE DESIGNED FOR DRIVER'S OR PASSENGER'S SIDE OF VEHICLE: DO NOT INTERCHANGE!**

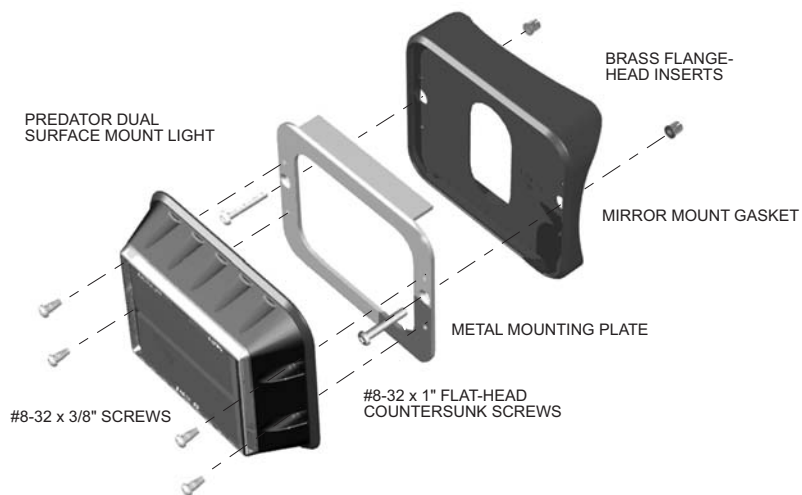
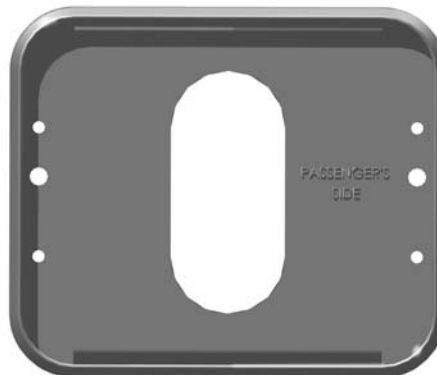

3900 Central Parkway

Hudsonville, MI 49426

toll free 800.338.7337

office 616.896.7100

techsupport@soundoffsignal.com

www.soundoffsignal.com

PREDATOR™

MIRROR MOUNT WARNING SYSTEM ASSEMBLY INSTRUCTIONS PPRDDMMFPI

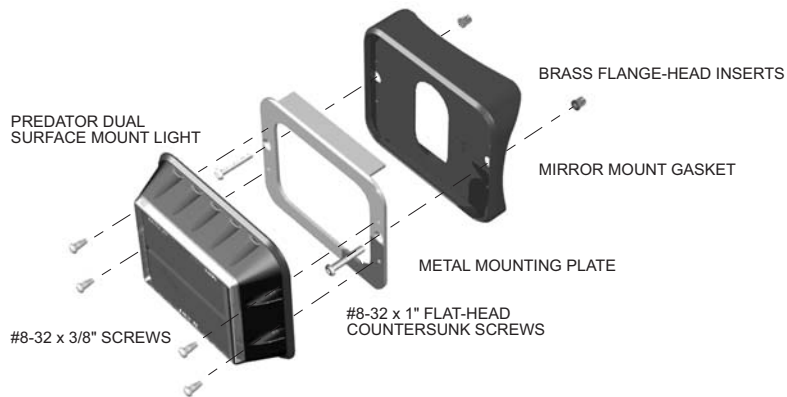
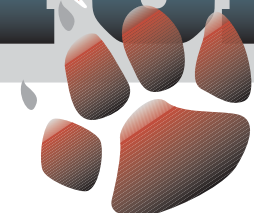

MOUNTING INSTRUCTIONS

1. Remove door panel and mirror assembly from door by removing hex screws and disconnecting harness connectors.
2. Remove mirror from mount by gently prying from carrier.

3. Carefully cut out template and tape to mirror shell noting top indication. The template shown is for the driver's side and will be used for the passenger's side by flipping template over. The edges of the template align with the seam of the mirror cover (See Illustration A) and a low-tack adhesive tape should be used so that template may be used for the passenger's side.

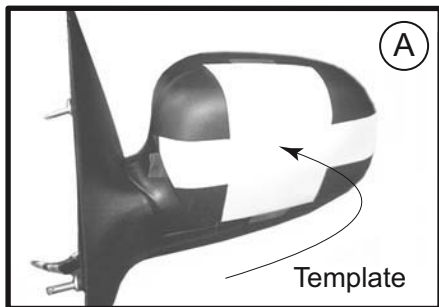

4. Drill 3/4"-1" hole at the center of the mounting hole pattern and two 7/32" holes to either side. The 7/32" holes will be 4-1/8" apart. Holes must be drilled slowly and carefully to prevent interior damage to mirror housing. A drill stop or other device is recommended for drilling holes.



5. Remove mirror from door and drill 3/8" hole through interior mirror bracket structure as shown (See Illustration C). The hole will be drilled between the threaded mounting stud and the existing mirror cable. When cable is inserted through this hole it is recommended that a quality RTV caulk be used to seal any potential leaks.

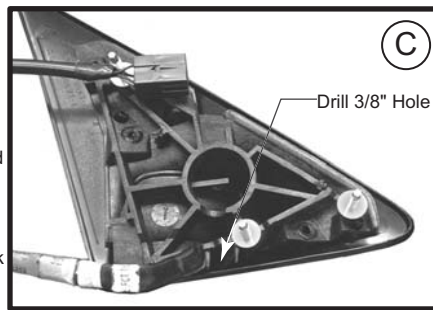

6. Route cable through center hole in gasket and through large hole in mirror housing (See Illustration D/E). Continue through hinged joint of mirror housing and follow existing wire bundle to ensure there is no interference with the operation of the window or mirror as this could cut the cable and make the light inoperative.
7. Re-install mirror on door and make appropriate electrical connections. Check for full travel of mirror and adjust cable slack if necessary. Electrical connections and pattern adjustment should be made at this time. Refer to Surface Mount instructions for details.
8. Insert brass flange-head inserts in 7/32" holes in housing (Illustration D).
9. Insert metal plate in gasket and attach to housing with #8-32 x 1" flat-head countersunk screws. Note that long leg of plate must be to the top of gasket.
10. Install light in gasket and secure with #8-32 x 3/8" self-threading screws. **DO NOT OVER TIGHTEN!**
11. When light is secure and operation is satisfactory, complete installation by reattaching door panel.

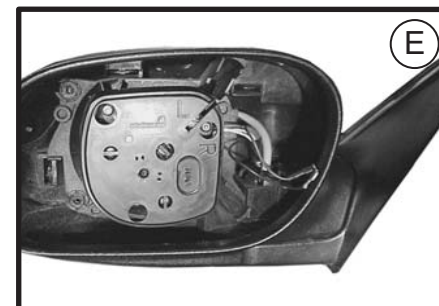
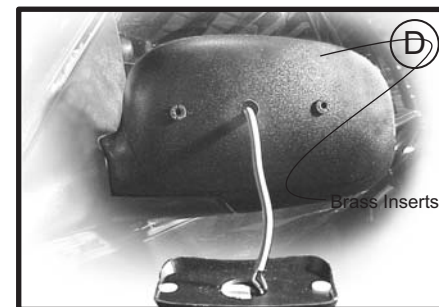

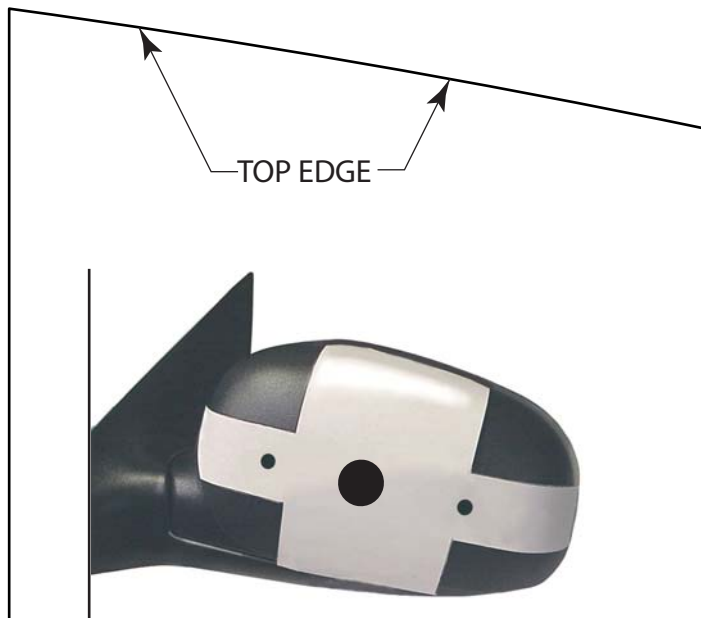
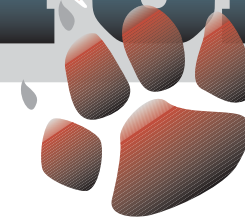

TEMPLATE TRIMMING AND MOUNTING INSTRUCTIONS

Important: To ensure accurate placement of the Galls Gen III Mirror Mount Warning Light System the installer must measure the distance between the 7/32" holes to be 4-1/8". This is to confirm the template has not been effected by humidity or printing irregularities. If there is significant variation the installer should enlarge or reduce the template as needed to make this distance the required 4-1/8".

1. Carefully cut out template and tape to mirror shell noting top indication. The template shown is for the **driver's side**. The edges of the template align with the seam of the mirror cover and a low-tack adhesive tape should be used to hold the template in place.
3. Drill 3/4"-1" hole at the center of the mounting hole pattern and two 7/32" holes to either side. The 7/32" holes will be 4-1/8" apart. Holes must be drilled slowly and carefully to prevent interior damage to mirror housing. A drill stop is recommended.

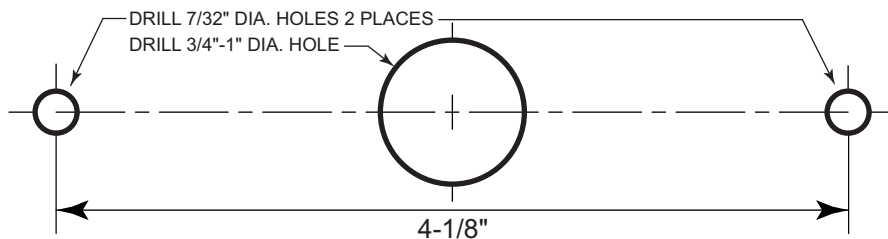

THIS TEMPLATE IS FOR DRIVER'S SIDE INSTALLATION.

TRIM CAREFULLY TO THIS LINE