

# IntelliSwitch993

**Digital Switch  
w/ Power Pursuit Buttons:  
#ETSP993**

2 Hidden Membrane Switches  
behind the logo

3 Power Pursuit Buttons can control any  
combination of the switches below



# IntelliSwitch990

**60 Amp Digital Switch:  
#ETSP990**

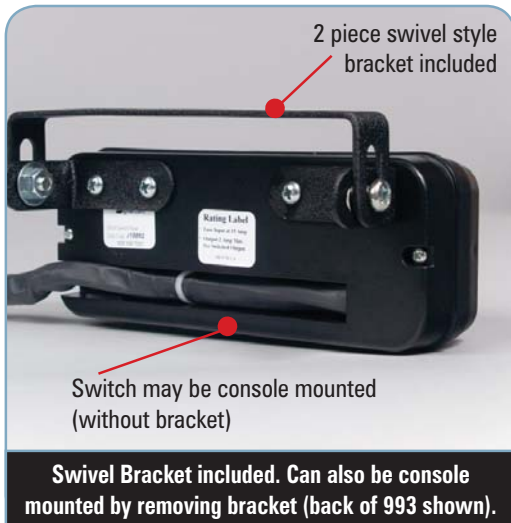

- **INTELLSwitch models offer high speed action, low current draw & increased reliability with efficient digital technology.** Both models feature Ryno-Tuf push buttons, 60 title legend sheets & optional bracket with mounting hardware. Switches can be console mounted if desired

- **Compact, slim design with self performing diagnostics** at power-up to ensure optimum performance. Both switches feature LED backlighting

- **INTELLSwitch993 model offers 11 programmable buttons:** 9 total Ryno-Tuf push buttons (3 Power Pursuit buttons) with 2 hidden "discreet" membrane buttons located behind the SoundOff logo. You can configure the Power Pursuit buttons to operate any combination of the 6 remaining push buttons automatically, eliminating hours of tedious wiring. The 2 hidden membrane switches can be programmed for discreet functions of your choice such as timed gun lock

- **INTELLSwitch990 model offers 6 Ryno-Tuf durable push buttons** that are fully programmable with 60 amps maximum output. One push button can be set as an 8 second timed momentary if needed



Tech Specs	INTELLSwitch™ 990 & 993
<b>Mounting:</b>	2-pc. swivel style bracket included or can be console mounted
<b>Input Voltage:</b>	12 Vdc
<b>Current Draw:</b>	#ETSP990 - 60 amps max #ETSP993 - 12 amps max
<b>Dimensions:</b>	Length x Height x Depth 6.5" (165 mm) L x 2.5" (64 mm) H x 2" (51 mm) D